

Post Filed This 6th day of Aug 1984
 And Recorded in Vol. 10-M Page 41
 Dennis S. Tankersley
 Register Meane Conveyance Greenville County, S. C.

10-M-41

Note:
 Iron Pins At All Property Corners.
 There is a 5' Drainage And Utilities
 Easement Along Each Side Of All Side
 And Rear Lot Lines.

RECORDING FEE
 \$5.00

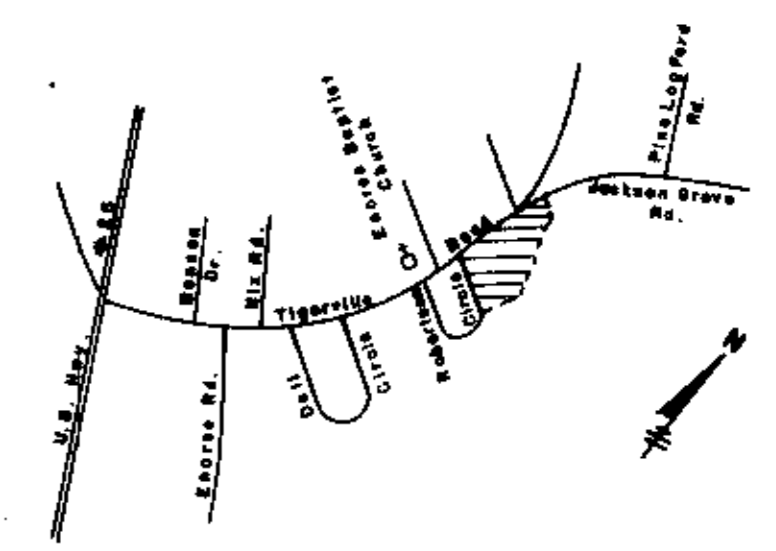

N. T. S.
 LOCATION MAP

FINAL PLAT

CERTIFICATE OF OWNERSHIP AND DEDICATION

"The undersigned hereby acknowledge that I am (we are) the owner(s) of the property shown and described hereon and that I (we) hereby adopt this plan of subdivision with my (our) free consent and that I (we) establish the minimum building restriction lines, and hereby dedicate to public use as roads, streets, and easements, forever all areas so shown or indicated on said plat.

3 Aug 84 Signed William E. Garner
 Signed _____
 Signed _____
 Signed _____

CERTIFICATE OF ACCURACY

"I, Jeffery M. Plumblee, certify that this plat was (drawn by me) (drawn under my supervision) (an actual survey made under my supervision) from (an actual survey made by me) (deed description recorded in Book _____ Page _____ Book _____ Page _____ etc.) (other); that the error of closure as calculated by latitudes and departures is 1/8000; that the boundaries not surveyed are shown as broken lines plotted from information found in Book _____ Page _____; that this plat was prepared in accordance with the Greenville County Subdivision Regulations as adopted.

July 25, 1984 DATE
 S. C. Registration No. 7881

CERTIFICATE OF APPROVAL FOR RECORDING

"I hereby certify that the subdivision plat shown hereon has been found to comply with the Subdivision Regulations for Greenville County, with the exception of such variances, if any, as are noted in the minutes of the Greenville County Planning Commission of Greenville County, South Carolina, and that it has been approved for recording in the office of the County Register of Meane Conveyance.
 8/16/84 DATE
 Director of Planning
 GREENVILLE COUNTY PLANNING COMMISSION

FILE NUMBER

84-156

SUMMARY PLAT

SECTION ONE
 SUNRISE ACRES

WILLIAM E. GARNER OWNER
 JEFFERY M. PLUMBLEE, INC. ENGINEER OR SURVEYOR

NO. OF ACRES: 6.05 MILES OF NEW ROADS: 0

NO. OF LOTS: 7 DATE: 7-25-84

ZONE: _____

SCALE: 1" = 100'



JEFFERY M. PLUMBLEE, INC.
 LAND SURVEYING

P. O. BOX 788
 TRAVELERS REST, S. C. 29689 (803) 834-4428